

Engineering Data Sheet
SM203, 10.8V, 2.75Ah, 30Wh
Cell: NCR18650



Dimensions

Millimeters Inches

	Maximum	Minimum	Maximum	Minimum
Thickness	22.40	21.64	.882	.852
Width	59.02	58.52	2.324	2.304
Length	85.12	84.62	3.351	3.331
Radius	10.94	10.93	.4307	.4303

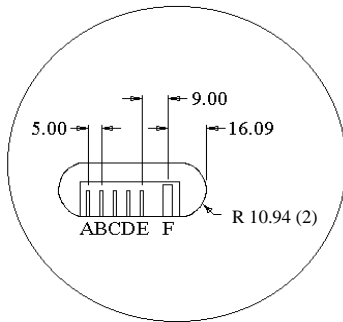

Terminals

- A - Negative
- B - Temperature
- C - Data
- D - Clock
- E - Positive
- F - Key

Mating Connector P/N: 787415-1

Chemical System: Lithium Ion (Li-Ion)
Battery Voltage: 10.8V
Nominal Capacity: 2750mAh
Watt hours: 28Wh

Nominal Weight: grams approximate
Capacity Availability: 2100mAh to 3200mAh

Capacity	Nominal	2750mAh
Effective Internal Resistance	Nominal	200 milliohms approx
Maximum Discharge Current	Continuous	3.5A @ 25°C
Charging	Charging Voltage:	12.6
	Charging Time @ 1A	100% In 3.5 hours
	Maximum Charging Current:	1A
Temperature	Storage (°C)	-20°C to +50°C
	Discharge (°C)	-20°C to +60°C
	Charge (°C)	0°C to +40°C